



Client
Cheshire Fire and Rescue Service

Location
Mollington, Cheshire

Project Value
£2.9m

Contractor
ISG

Architect
TACP Architects Ltd

Start
November 2015

Completion
September 2016

Sector
Bluelight

Form of contract
JCT Design & Build

Delivery type
Design & Build

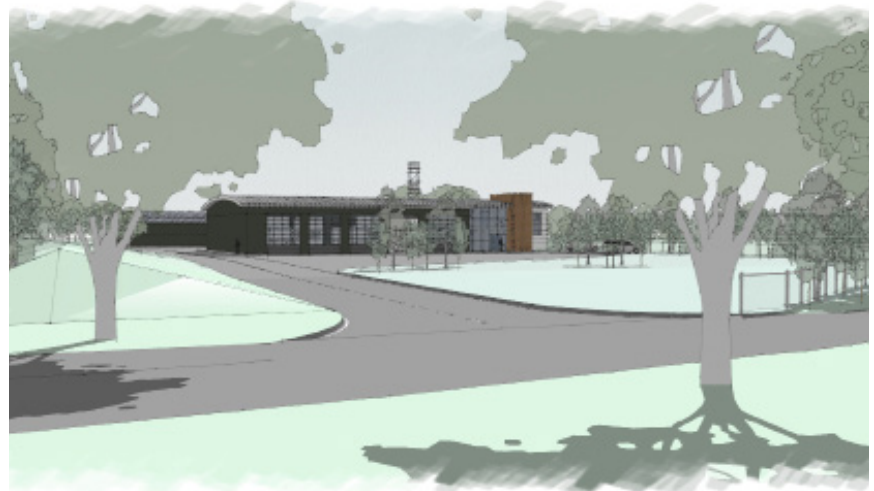

Construction of a new two-storey five-bay fire station on Powey Lane in Mollington, close to the M56. The project area totals 10,500 sqm

School Engagement and Student Development

- The contractor has established links with Mid Cheshire College and Warrington Collegiate, to offer site visits and work experience opportunities within its supply chain

Sustainability and Localism

- A Supply Chain Open Day was held in Cheshire supported by Mid Cheshire College and Cheshire West and Chester Council and attended by over 100 local suppliers
- The local Jobcentre Plus has been engaged to create a pathway into work for local unemployed people and links have been forged with the Princes Trust to offer work placements
- Regular community briefings will be held to provide project updates to include question and answer sessions
- To promote the scheme, a groundbreaking event was organised with representatives of Cheshire Fire Authority
- The contractor donated prizes to the Cheshire Fire Authority Staff and Cadet annual awards event

For more information please contact:
NWCH Management Team

Email: nwch@nwconstructionhub.org

Tel: 0161 219 6525

Web: <http://nwconstructionhub.org>



We are delighted to be working with ISG on this exciting programme, which will ensure that we continue to protect communities across Cheshire. ISG's commitment to creating training and employment opportunities for local people, their clear commitment to promoting equality and diversity and their vast experience of working with blue light services were key factors in our decision and we look forward to seeing the project benefits."

Richard Ost, Assistant Chief Fire Officer, Cheshire Fire and Rescue Service